

ORDINANCE NO. 1592 (13)

**An Ordinance of the City Council of the City of Lompoc,
County of Santa Barbara, State of California, Amending the
City Zoning Map for the Proposed Summit View Homes
Residential Development**

**THE CITY COUNCIL OF THE CITY OF LOMPOC DOES, HEREBY, ORDAIN AS
FOLLOWS:**

SECTION 1. The City Council hereby finds and determines:

- A. The Planning Commission did by Resolution No. 752 (13), following a public hearing in the time and manner prescribed by law, recommend pre-zoning of property described hereinafter.
- B. The City Council has held a public hearing in the time and manner prescribed by law and has duly heard and considered the recommendation and directed staff to proceed with an Ordinance implementing the Zone Change at this time.
- C. The City Council finds the zone change is consistent with the land use and density proposed by the Summit View Homes Residential project.
- D. The City Council certified the Final Environmental Impact Report for the Summit View Homes Residential Development project (EIR 12-01) (SCH No. 2012071088) on May 21, 2013, as required by the California Environmental Quality Act (CEQA).

SECTION 2. The subject property is generally illustrated on Exhibit A, attached hereto and incorporated herein by this reference, and more particularly described as Assessor Parcel Number 97-250-034.

SECTION 3. The subject property is hereby pre-zoned in the manner stated below and the Zoning Map is amended accordingly:

Single-Family Residential, Planned Development – 7-R-1, PD

SECTION 4. This Ordinance shall be effective thirty (30) days after its enactment.

PASSED AND ADOPTED this 21st day of May, 2013, by the following electronic vote:

AYES: Councilmember:

NOES: Councilmember:

John H. Linn, Mayor
City of Lompoc

ATTEST:

Stacy Alvarez, City Clerk
City of Lompoc

Attachment A – Map

ZC 12-01

SCALE: 1" = 300'



- 7-R-1 Single Family Residential
- 7-R-1 PD S.F.R. Planned Development
- OS Open Space
- SP Specific Plan

PROPOSED

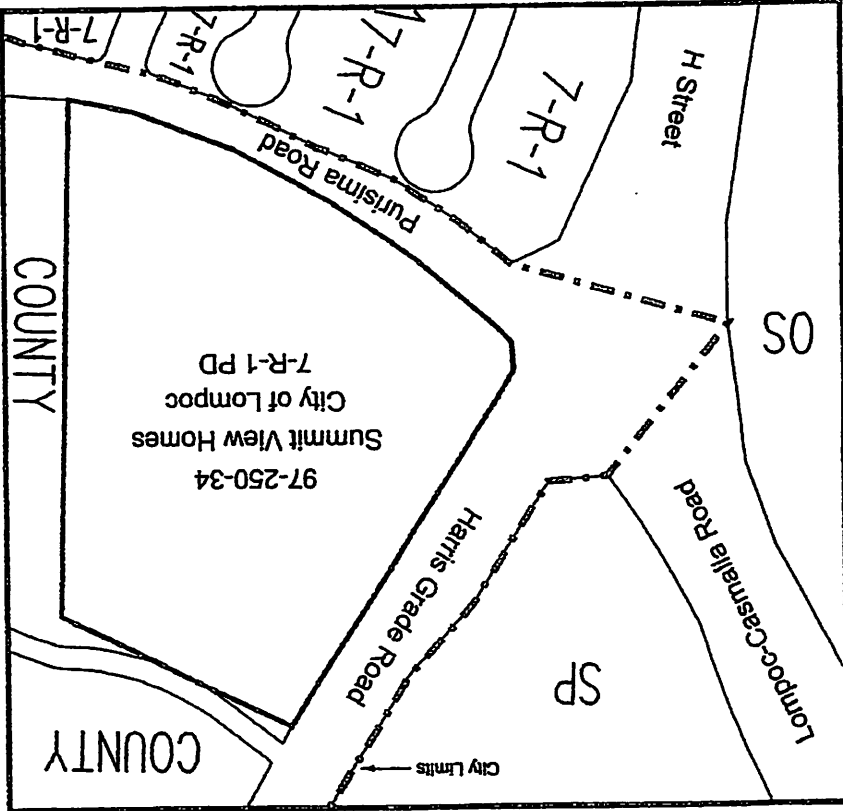

EXISTING

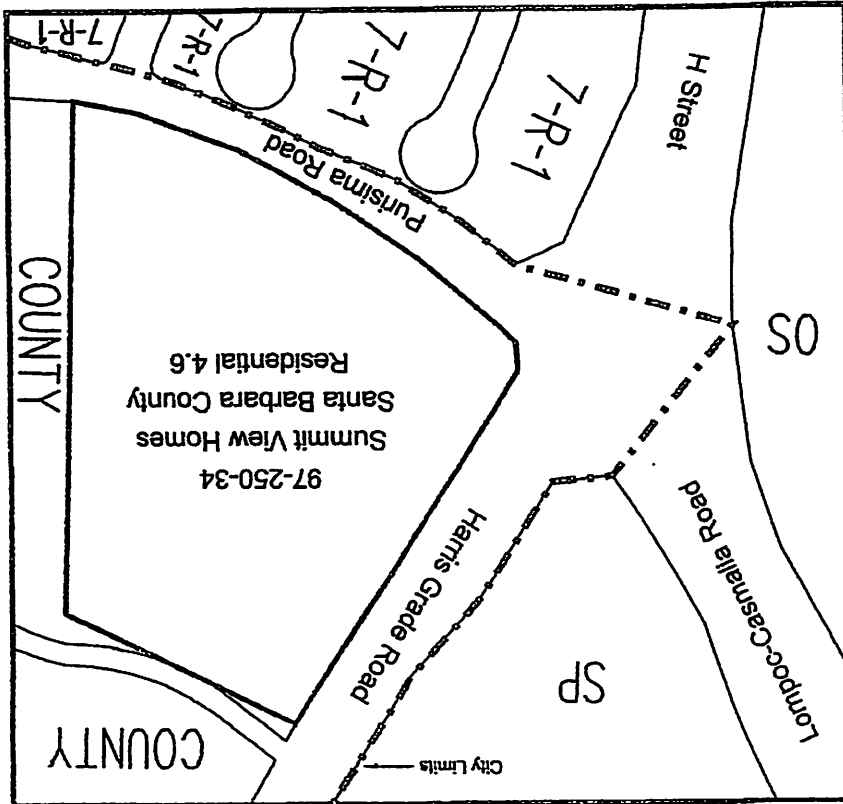

ZONE CHANGE